

MATERIAL:

- STANDARD AND ANI-STATIC FOAMS AVAILABLE - CONTACT US TO REVIEW OPTIONS.
- TRAY SIZE 12X9 WITH 80 CAVITIES. DEPTH OF CAVITY CAN BE ADJUSTED BASED ON APPLICATION.
- .75" DIAMETER CAVITIES

.75
CAVITY DEPTH
(CAN VARY BASED ON APPLICATION.
CALL FOR DETAILS)

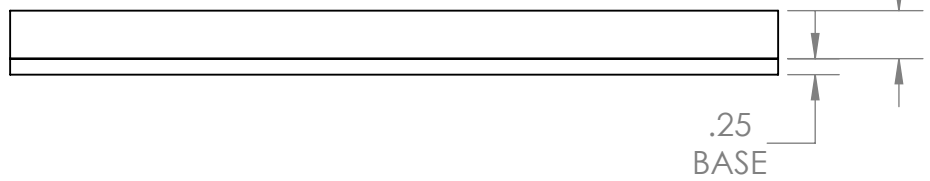

ENGINEERED & PACKAGING, LLC

<p>PROPRIETARY AND CONFIDENTIAL</p> <p>THE INFORMATION CONTAINED IN THIS DRAWING IS THE SOLE PROPERTY OF ENGINEERED COMPONENTS & PACKAGING LLC. ANY REPRODUCTION IN PART OR AS A WHOLE WITHOUT THE WRITTEN PERMISSION IS PROHIBITED.</p>	UNLESS OTHERWISE SPECIFIED:	MATERIAL	COMMENTS:	TITLE: 12X9-80
	DIMENSIONS ARE IN INCHES	SEE NOTE	Contact ECP for details.	SIZE DWG. NO.
	TOLERANCES:	FINISH	info@ecpplastictrays.com	REV
	FRACTIONAL ±	DO NOT SCALE DRAWING	(585) 204-6770	A ECP
	ANGULAR: MACH ± BEND ±			2
	TWO PLACE DECIMAL ± .03			
	THREE PLACE DECIMAL ± .02			
				SCALE: 1:3
				SHEET 1 OF 1